

FORD: 1994-1997 F SUPER DUTY
1999 SUPER DUTY F SERIES

This TSB article is being republished in its entirety to include vehicles through the 1999 model year and to revise the warranty statement.

ISSUE

This TSB provides instructions for setting “clear vision” or steering wheel alignment.

ACTION

Refer to the Service Procedure to obtain steering wheel alignment.

SERVICE PROCEDURE

There are separate clear vision setting procedures for the 1994-97 model year and the 1999 model year. Follow the appropriate procedure for the model year chassis being serviced.

1994-97 Model Years

1. Align the front wheels to the straight ahead position. This can most accurately be achieved by driving the vehicle straight for about 15 meters (50 ft).
2. From under the vehicle, remove the bolt which attaches the coupling shaft to the steering gear. Refer to Figure 1.
3. Remove the coupling shaft from the steering gear using light force on the yoke with a pry bar or by lightly tapping the yoke with a screwdriver and a hammer.
4. Turn the steering wheel to the straight ahead position.
5. Reinstall the coupling shaft to the steering gear, moving the steering wheel as required to align the coupling shaft splines with the steering gear input shaft splines.

NOTE

BECAUSE OF THE LIMITATIONS OF TOLERANCE STACK-UP AND THE NUMBER OF SPLINES ON THE STEERING GEAR, IT MAY NOT BE POSSIBLE TO GET PERFECT

ALIGNMENT OF THE STEERING WHEEL. IT CAN USUALLY BE ADJUSTED TO WITHIN 5 DEGREES OF CENTER WHEN DRIVING STRAIGHT DOWN THE ROAD.

6. Install a new coupling shaft yoke attachment Bolt (N803942-S100) and torque to 41-57 N•m (30-42 lb-ft). If the old bolt is reused in lieu of a new one, it must be reinstalled with Threadlock and Sealer (E0AZ-19554-AA, or equivalent meeting Ford Specification WSK-M2G351-A5).

1999 Model Year

1. Align the front wheels to the straight ahead position. This can most accurately be done by driving the vehicle straight ahead for about 50 ft (15 meters).
2. Remove the steering wheel as outlined in the 1999 F-Super Duty Workshop Manual, Section 211-04.
3. Adjust the steering wheel to the straight ahead position and insert it back onto the splined shaft of the steering column.

NOTE

DUE TO THE NUMBER OF SPLINES ON THE STEERING COLUMN SHAFT, IT MAY NOT BE POSSIBLE TO PERFECTLY ALIGN THE STEERING WHEEL. THE NUMBER OF SPLINES ON THE STEERING COLUMN ALLOWS ALIGNMENT WITHIN 4.5 DEGREES OF CENTER.

4. Install a new steering wheel attachment Bolt (N807493-S100) and torque to 34-46 N•m (25-34 lb-ft). If the old bolt is reused in lieu of a new one, it must be reinstalled with Threadlock And Sealer (E0AZ-19554-AA or equivalent meeting Ford specification WSK-M2G351-A5).

NOTE

FOR THE 1999 F-53, CLEAR VISION SHOULD ONLY BE ADJUSTED AT THE STEERING WHEEL. DO NOT ADJUST IT AT THE STEERING GEAR.

Article No. 98-21-20 Cont'd.

PART NUMBER	PART NAME
N803942-S100	Bolt (Pk/3) - 1994-97
N807493-S100	Bolt - 1999
E0AZ-19554-AA	Threadlock And Sealer

OTHER APPLICABLE ARTICLES: NONE

SUPERSEDES: 96-24-14

WARRANTY STATUS: Eligible Under The Provisions Of Bumper To Bumper Warranty Coverage For 1994-97; 1999 Vehicles

Ineligible For Warranty Coverage

OPERATION	DESCRIPTION	TIME
982120A	Correct Clear Vision - 1994-97 Only	0.4 Hr.

DEALER CODING

BASIC PART NO.
19554

OASIS CODES: 303000

CONDITION
CODE
12

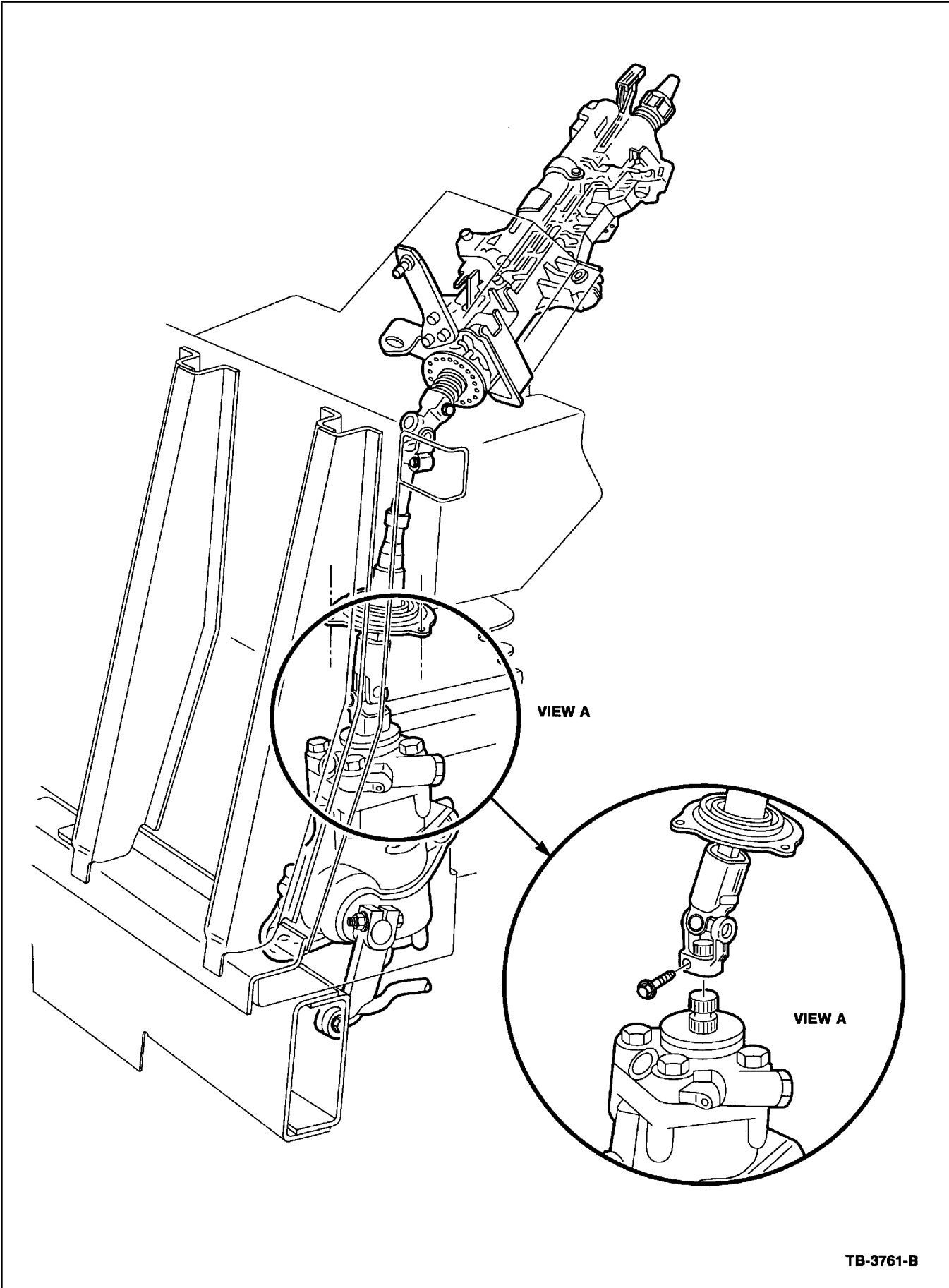

TB-3761-B

Figure 1 - Article 98-21-20