



**FLEETWOOD  
MOTORHOME SLIDE-OUT  
SYSTEMS  
OPERATIONS MANUAL**

Part No. 82-S0010-01  
January 18, 1999  
(REFERENCE 81-1295)

# TABLE OF CONTENTS SECTION

<u>SECTION</u>	<u>PAGE</u>
I. System Description	3
II. How To Operate Your Slide-Out System	4
III. Overriding Your Slide-out System	5
Overriding Your Main Room Slide-out System	6
Overriding Your Bedroom Slide-Out System	6
IV. Electrical Wiring Information	8
V. Preventative Maintenance	9
<b>Warranty Statement</b>	10

# OPERATIONS MANUAL

The Power Gear electric slide-out system in your unit is designed to give you years of trouble free operation and reflects the latest state of the art technology. **Read, study, and understand this manual before operating this slide-out system.**

## I. SYSTEM DESCRIPTION

**The Power Gear Slide-Out System Consists of 4 Major Components:**

1. Two inner rail assemblies (one for bedroom or wardrobe) designed to support the room weight.
2. A 12 Volt DC motor and drive shaft that will operate the room using power from the on-board unit battery.
3. A manual override system that allows you to extend / retract the room in the event of loss of power.
4. A specially designed control that gives the user full control of the room movement in or out. The control has a load sensing capability that stops the motor when the room reaches it's fully extended or retracted positions.

## **!WARNING!**

**ALWAYS MAKE SURE THAT THE UNIT IS LEVEL BEFORE OPERATING THE SLIDE-OUT ROOM.**

**ALWAYS MAKE SURE THERE ARE NO OBSTRUCTIONS BLOCKING THE PATH OF THE ROOM WHEN IT IS MOVING.**

**ALWAYS MAKE SURE THAT THE ROOM PATH IS CLEAR OF PEOPLE AND OBJECTS BEFORE OPERATING.**

**ALWAYS KEEP AWAY FROM THE SLIDE RAILS WHEN THE ROOM IS IN MOTION. THE GEAR ASSEMBLY MAY PINCH OR CATCH ON LOOSE CLOTHING CAUSING PERSONAL INJURY.**

**FAILURE TO FOLLOW THESE INSTRUCTIONS  
COULD RESULT IN SERIOUS INJURY OR DEATH.**

## II. HOW TO OPERATE THE SLIDE-OUT SYSTEM

BEFORE YOU OPERATE THE POWER GEAR SLIDE-OUT SYSTEM MAKE SURE:

- (A) The path for the room to move is clear.
- (B) The battery is fully charged and hooked-up to the unit's electrical system.
- (C) The unit is level.

### EXTENDING THE ROOM

STEP 1 - Insert the switch key into the slide out room control.

STEP 2 - Turn the switch key to the "OUT" position.

STEP 3 - Hold the switch in the "OUT" position until the room is fully extended and stops moving. The control will sense that the room has stopped and will automatically shut off the motor, locking the room into place.

STEP 4 - Release the switch key.

STEP 5 - The key may now be removed from the switch if necessary.

### SLIDE-OUT SWITCH

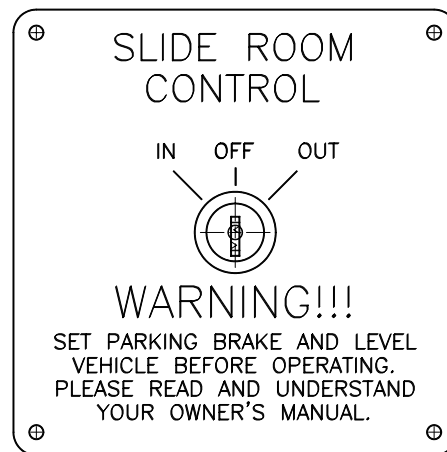

### RETRACTING THE ROOM

STEP 1 - Insert the switch key into the slide out room control.

STEP 2 - Turn the switch key to the "IN" position.

STEP 3 - Hold the switch in the "IN" position until the room is fully retracted and stops moving. The control will sense that the room has stopped and will automatically shut off the motor, locking the room into place.

STEP 4 - Release the switch key.

STEP 6 - The key may now be removed from the switch if necessary.



### III. OVERRIDING YOUR SLIDE-OUT SYSTEM

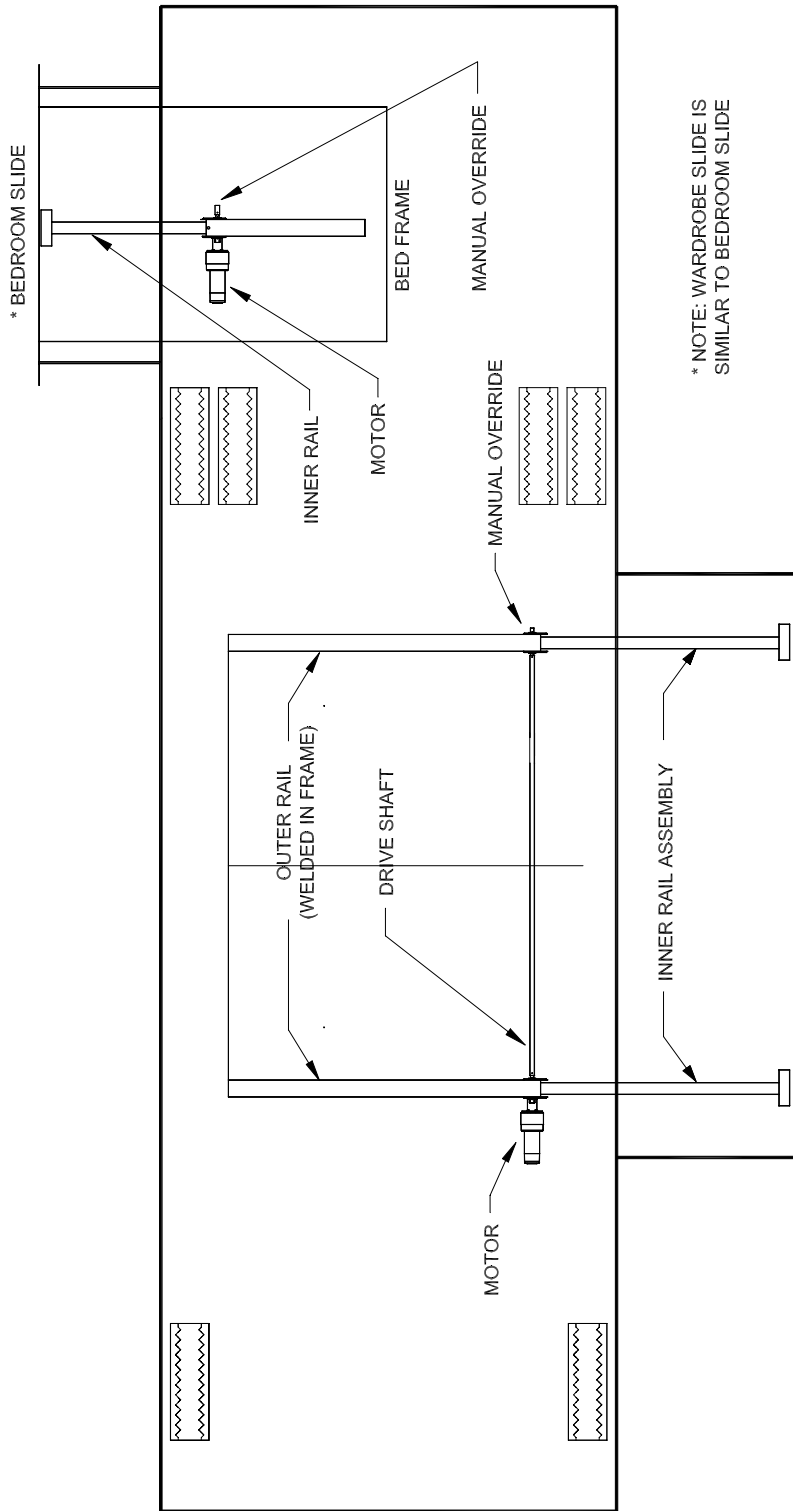

## MOTORHOME SLIDEOUT

Your Power Gear slide-out system is equipped with a manual override that allows you to extend or retract a room in the event of a loss of power.

If your system will not move when the switch is pressed make sure that: **the system is turned on, the battery is connected and has a full charge.** After all of these are completed, then follow these simple steps to move the room manually.

## **A. MAIN ROOM SLIDE**

STEP 1 - Make sure that the ON/OFF switch/key for the system is turned off.

STEP 2 - Locate the slide-out motor. It will be either ahead of the front rail or behind back rail.

STEP 3 - Locate the two pin connector on the slideout motor leads and disconnect.

STEP 4 - Rotate the lever on the backside of the motor counter-clockwise about 1/8 turn (looking from the rear of the motor). This will release the break that holds the room in place.

STEP 5 - The room is now free to move. Using a 3/4" wrench or ratchet, crank the room either in or out completely (depending on your need) using the manual override.

STEP 6 - When the room is fully in (or out) have one person put pressure on the wrench/ratchet to ensure a tight seal while the another person returns the brake lever to it's normal downward locked travel position. This will ensure that the room is locked into a sealed position.

STEP 7 - Take the unit to an authorized dealer for service.

## **B. BEDROOM/WARDROBE SLIDE-OUT**

STEP 1 - Make sure that the ON/OFF switch/key for the system is turned off.

STEP 2 - Access the slideout mechanism.

To access the bedroom slide out, lift up the mattress and base board.

To access the wardrobe slide out, open the outside luggage compartment below the wardrobe.

STEP 3 - Locate the two pin connector on the slideout motor leads and disconnect.

STEP 4 - The bedroom slide-out motor has a lever on the backside. Rotate the lever counter-clockwise about 1/8 turn (looking from the rear of the motor). This will release the brake that locks the room in place.

STEP 5 - Use an appropriate wrench (3/4" wrench/ratchet, or adjustable wrench) on the override to move the room in (or out). The override is located on the opposite side of the slide-out rail from the motor.

STEP 6 - Once the room is in (or out), apply pressure to the wrench so that the room is sealed and return the brake lever to it's normal downward position (to lock the room in place).

STEP 7 - Take the unit to an authorized dealer for service.

# **!WARNING!**

**WHEN THE SLIDE-OUT ROOM MOTOR BRAKE LEVER IS RELEASED THE ROOM WILL NOT LOCK INTO PLACE, AND THEREFORE IT WILL NOT BE SEALED FROM THE OUTDOORS!**

**WHEN THE ROOM HAS BEEN CRANKED IN BE SURE TO RETURN THE MOTOR BRAKE LEVER TO IT'S NORMAL DOWNWARD POSITION IN ORDER TO SEAL AND LOCK THE ROOM.**

## **MAIN ROOM MOTOR**

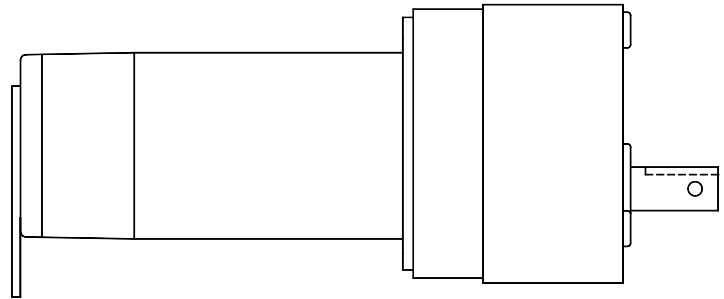
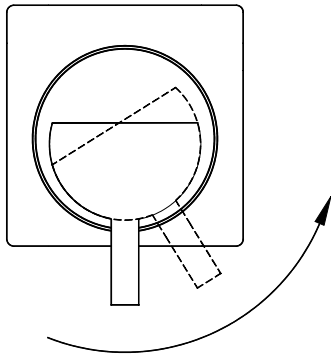

**ROTATE TO  
RELEASE BRAKE**

## **BEDROOM / WARDROBE MOTOR WITH BRAKE RELEASE**

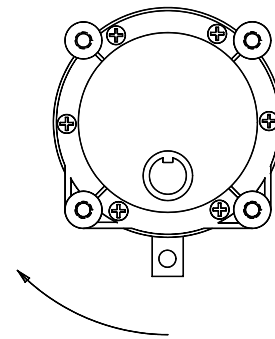
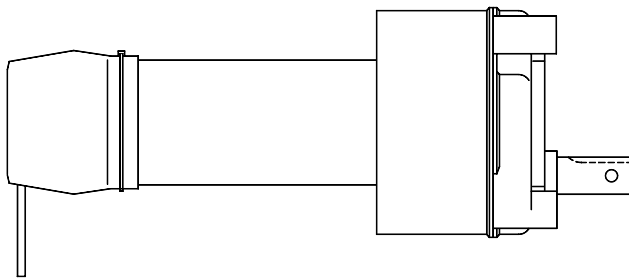

**ROTATE TO  
RELEASE BRAKE**



950 Green Valley Rd.  
Beaver Dam, WI 53916  
Phone: 1-800-334-4712  
Fax: 920-887-0841

## ELECTRICAL WIRING INFORMATION

The wiring for the slide-out should be completed per the following wiring diagram.

The switch wires, motor wires and ground wire can be connected to the control at any time during installation prior to the power being connected. The battery line must be connected to the control **BEFORE** the battery is connected. **NOTE:** If motor runs in reverse direction, switch motor leads. **CAUTION:** The control box **WILL** be damaged if any of the leads are grounded or touched together when power is connected to the system.

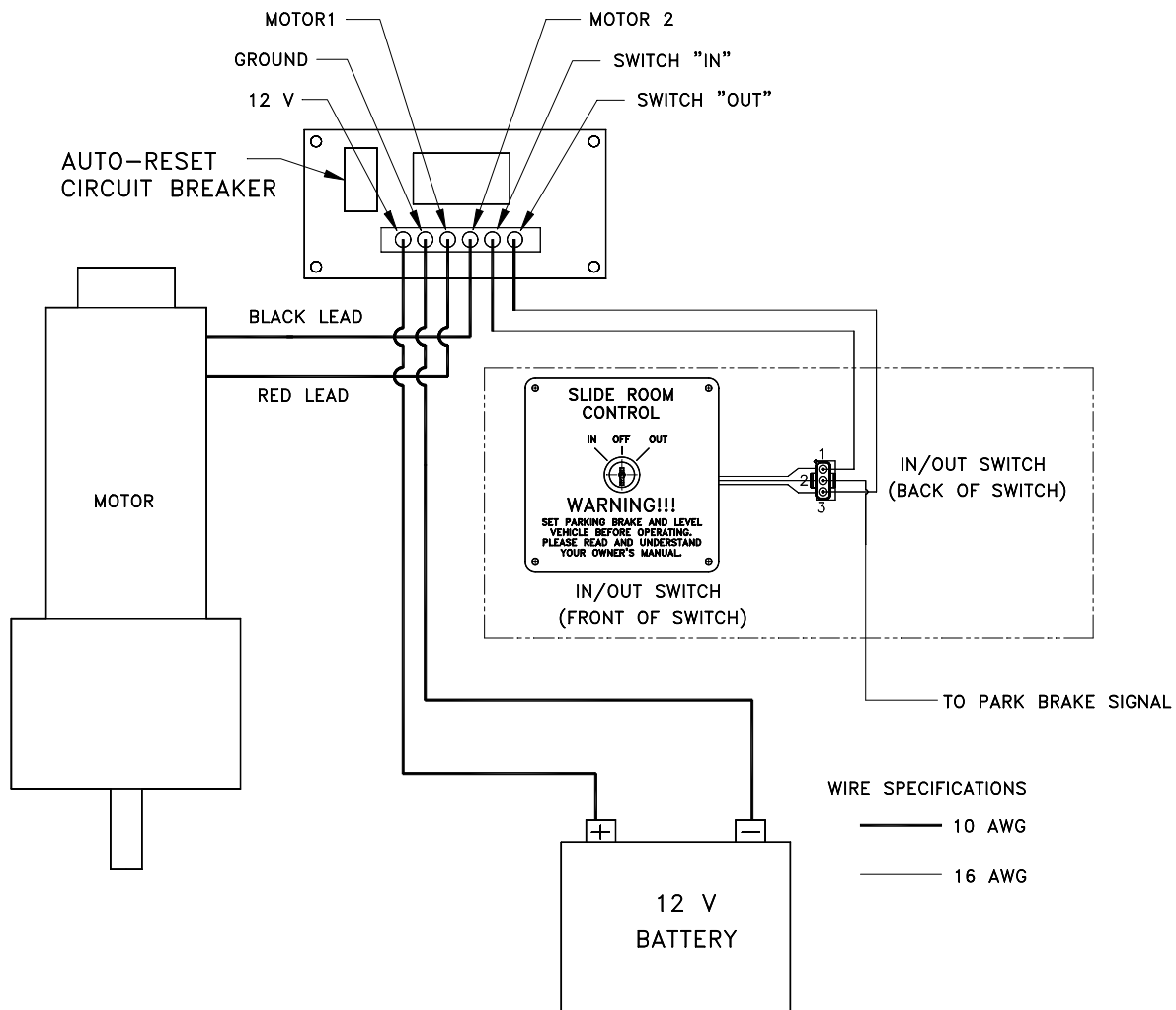

Your Power Gear slide-out system has been designed to require very little maintenance. To ensure the long life of your slide-out system, read and follow these few simple procedures.

**CAUTION: DO NOT WORK ON YOUR SYSTEM UNLESS THE BATTERY IS DISCONNECTED.**

- When the room is out, visually inspect the inner slide rail assemblies. Check for excess build-up of dirt or other foreign material; remove any debris that may be present.
- If the system squeaks or makes any noises it is permissible to apply a coat of light weight oil to the drive shaft and roller areas. Remove any excess oil so dirt and debris do not build-up.

**IF YOU HAVE ANY PROBLEMS OR QUESTIONS CONSULT YOUR  
LOCAL AUTHORIZED DEALER OR CALL US AT POWER GEAR  
800-334-4712**

## POWER GEAR LIMITED WARRANTY

Power Gear warrants to the original retail purchaser that the product will be free from defects in material and workmanship for a period of two (2) years following the retail sales date. Power Gear will, at its option, repair or replace any part covered by this limited warranty which, following examination by Power Gear or its authorized distributors or dealers, is found to be defective under normal use and service. No claims under this warranty will be valid unless Power Gear or its authorized distributor or dealer is notified in writing of such claim prior to the expiration of the warranty period. Warranty is non-transferable.

### **THIS WARRANTY SHALL NOT APPLY TO:**

- Failure due to normal wear and tear, accident, misuse, abuse, or negligence.
- Products which are modified or altered in a manner not authorized by Power Gear in writing.
- Failure due to misapplication of product.
- Telephone, telegraph, teletype or other communication expenses.
- Living or travel expenses of person performing service.
- Overtime labor.
- Failures created by improper installation of the product's slideout system or slideout room to include final adjustments made at the plant for proper room extension/retraction; sealing interface between slideout rooms and side walls; synchronization of inner rails; or improper wiring or ground problems.
- Failures created by improper installation of leveling systems, including final adjustments made at the plant, or low fluid level, wiring or ground problems.
- Replacement of normal maintenance items including lubricants and fuses.

There is no other express warranty other than the foregoing warranty. **THERE ARE NO IMPLIED WARRANTIES OF MERCHANTABILITY OR FITNESS FOR A PARTICULAR PURPOSE. IN NO EVENT SHALL POWER GEAR BE LIABLE FOR ANY INCIDENTAL OR CONSEQUENTIAL DAMAGES.** This warranty gives you specific legal rights, and you may also have other rights which vary from state to state. Some states do not allow the limitations of implied warranties, or the exclusion of incidental or consequential damages, so the above limitations and exclusions may not apply to you.

For service contact your nearest Power Gear authorized warranty facility or call 1-800-334-4712. Warranty service can be performed only by a Power Gear authorized service facility. This warranty will not apply to service at any other facility. At the time of requesting warranty service, evidence of original purchase date must be presented.

**Power Gear  
a unit of APW Engineered Solutions  
950 Green Valley Road  
P.O. Box 695  
Beaver Dam, WI 53916-0695  
800/334-4712**